

# SWFcontract™



**Solar Shading  
Systems**



## COMPARISON SHEET - SOLAR SHADING SYSTEMS

SWFcontract™ solar shading systems provide function, flexibility, and a clean design aesthetic for managing sunlight in today's commercial interiors. A broad collection of light filtering fabrics contributes to optimizing natural light while controlling heat and glare.

### Product Features - MANUAL SHADES

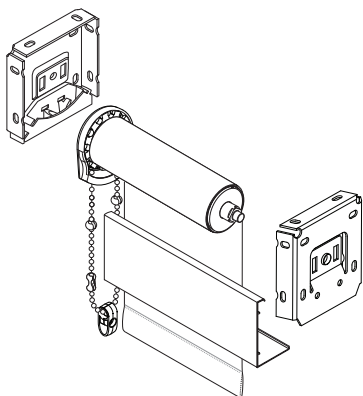

- TruePerformance chain operated clutch system
- Extruded aluminum roller tube with spline channel
- Unique co-extruded spline is heat-welded to fabric, providing secure attachment to tube while allowing easy removal of fabric band
- Fully enclosed, heat-sealed hem pocket
- Dual and coupled shades
- Solar and blackout fabric collection including Microban, GREENGUARD Gold and PVC-free
- Optional fascia, pockets, closure plates, side, and sill channels
- Limited lifetime warranty

### Product Features - MOTORIZED SHADES

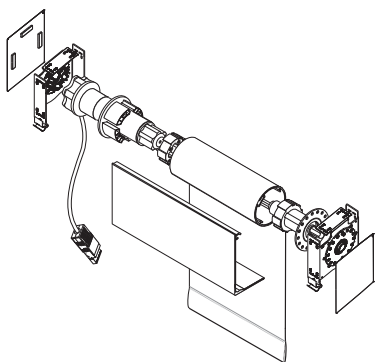

- Standard, extended, and heavy-duty motorized systems
- Somfy® motors with state-of-the-art controls
- Quick disconnect plugs
- Adjustable idle end brackets allow shades to be leveled in place
- Extruded aluminum roller tube with spline channel
- Unique z-shaped spline is heat-welded to fabric providing secure attachment to tube while allowing easy removal of fabric band
- Fully enclosed, heat-sealed hem pocket
- Dual and coupled shades
- Solar and blackout fabric collection including GREENGUARD Gold and PVC-free
- Optional fascia, pockets, closure plates, side, and sill channels
- Unique fascia with clip
- Limited lifetime warranty
- 5 year limited warranty on motorization components and accessories (battery not included)

We offer three types of motors: intelligent, radio frequency, and standard. Each type provides different features and benefits.

### Intelligent Motors:

- Somfy® Sonesse 30 24V DC 2Nm powerful and quiet motor for smaller profile windows
- Somfy Sonesse 50 quiet and LT50 high torque 120V AC 3-wire motors can plug directly to building power
- Intelligent and addressable motorization
- Reliable wired communications
- 16 intermediate positions available
- Addressable switches can be reprogrammed without rewiring
- Somfy ILT control options
  - Addressable switches
  - Sun sensor
  - Timers
  - RTS control
  - Building automation control systems
- Capable of integration through RS232/RS485, dry contacts, Z-Wave, ZigBee, HTTP commands
- Addressable switches can be reprogrammed without rewiring
- Intelligent and addressable motorization
- Most extensive motor technology capable of building control, automation and user interfaces used in new and retrofit construction when system flexibility is desired

### Radio Frequency Motors:

- Somfy LT30 12V DC motor with wire-free power options
- Somfy Sonesse 30 24V DC 2Nm powerful and quiet motor for smaller profile windows
- Somfy Sonesse 40 120V AC 4Nm powerful and quiet motor for smaller profile windows
- Somfy Sonesse 50 quiet and LT50 high torque 120V AC 3-wire motors can plug directly to building power
- Wire-free communications
- Programmable intermediate position
- Somfy RTS control options
  - Handheld remotes
  - Wire-free wall switches
  - Sun sensors
  - Timers
- Capable of integration through RRS232/RS485, dry contacts, Z-Wave, ZigBee
- Easy to install
- Great for retrofits and difficult to wire applications
- Top technology choice for smaller applications with advanced control options

### Standard Motors:

- Somfy Sonesse™ 50 quiet and Somfy LT50 high torque 120V AC 4-wire motors available to fit any size project
- Group control options
  - Individual Group Control – IGC-II/3N1
  - Group Control System – GCS-II
  - animeo IB+ Motor Controller
- Push button or paddle switch control
- Capable of integration through dry contacts or RS232 connections
- Over 30 years field installed, proven technology
- Most common motor choice using sturdy wired topology—great solution for cost-conscious new construction projects capable of meeting wiring requirements

# SOLAR FABRIC COLLECTION

Collection	Openness	Fabric Width	Fabric Composition	Green Attributes
<b>SWFcontract Proprietary Fabrics</b>				
Double - Take T100 (Reversible Twill)	0-1%	98"	22% polyester / 78% vinyl on polyester	GREENGUARD Gold
Double - Take T300 (Reversible Twill)	3%	98"	22% polyester / 78% vinyl on polyester	GREENGUARD Gold
Double - Take T500 (Reversible Twill)	5%	98"	22% polyester / 78% vinyl on polyester	GREENGUARD Gold
Crosshatch A300	3%	98"	15% polyester / 85% vinyl on polyester	GREENGUARD Gold
Crosshatch A500	5%	98"	15% polyester / 85% vinyl on polyester	GREENGUARD Gold
<b>Phifer Fabric</b>				
SheerWeave Infinity 2	3%	98"	100% TPO (Thermoplastic Olefin), 20% TPO fiber yarn / 80% TPO coating on TPO yarn	PVC Free/GREENGUARD Gold
SheerWeave Infinity 2	5%	98"	100% TPO (Thermoplastic Olefin), 20% TPO fiber yarn / 80% TPO coating on TPO yarn	PVC Free/GREENGUARD Gold
SheerWeave 1000	25%	84"	35% fiberglass / 65% vinyl on fiberglass	GREENGUARD Gold
SheerWeave 2000	5%	72"/96"/126"	37% fiberglass / 63% vinyl on fiberglass	GREENGUARD Gold
SheerWeave 2100	10%	72"/96"	37% fiberglass / 63% vinyl on fiberglass	GREENGUARD Gold
SheerWeave 2360	10%	63"/98"	35% fiberglass / 65% vinyl on fiberglass	GREENGUARD Gold
SheerWeave 2390	5%	63"/98"/126"	35% fiberglass / 65% vinyl on fiberglass	GREENGUARD Gold
SheerWeave 2410	3%	63"/98"/126"	35% fiberglass / 65% vinyl on fiberglass	GREENGUARD Gold
SheerWeave 2500	1%	63"/98"	37% fiberglass / 63% vinyl on fiberglass	GREENGUARD Gold
SheerWeave Performance Plus 2390	5%	63"/98"	34% fiberglass / 64% vinyl on fiberglass / 2% aluminum coating	GREENGUARD Gold
SheerWeave Performance Plus 2410	3%	63"/98"	34% fiberglass / 64% vinyl on fiberglass / 2% aluminum coating	GREENGUARD Gold
SheerWeave 2701	1%	63"/98"	37% fiberglass / 63% vinyl on fiberglass	GREENGUARD Gold
SheerWeave 2703	3%	63"/98"	37% fiberglass / 63% vinyl on fiberglass	GREENGUARD Gold
SheerWeave 2705	5%	63"/98"	37% fiberglass / 63% vinyl on fiberglass	GREENGUARD Gold
SheerWeave 2710	10%	63"/98"	37% fiberglass / 63% vinyl on fiberglass	GREENGUARD Gold
SheerWeave 3000	14%	72"/96"	35% fiberglass / 65% vinyl on fiberglass	GREENGUARD Gold
SheerWeave 4000 with DOW Ecolibrium	5%	63"/98"/126"	25% polyester / 75% vinyl on polyester	GREENGUARD Gold
SheerWeave 4100 with DOW Ecolibrium	10%	63"/98"	25% polyester / 75% vinyl on polyester	GREENGUARD Gold
SheerWeave 4400 with DOW Ecolibrium	3%	63"/98"/126"	25% polyester / 75% vinyl on polyester	GREENGUARD Gold
SheerWeave 4500	5%	63"/98"	17% polyester / 83% vinyl on polyester	GREENGUARD Gold
SheerWeave 4550	5%	63"/98"	17% polyester / 83% vinyl on polyester	GREENGUARD Gold
SheerWeave 4600	3%	63"/98"	17% polyester / 83% vinyl on polyester	GREENGUARD Gold
SheerWeave 4650	3%	63"/98"	17% polyester / 83% vinyl on polyester	GREENGUARD Gold
SheerWeave 4800	1%	63"/98"	24% polyester / 76% vinyl on polyester	GREENGUARD Gold
SheerWeave 5000**	Varies by Color	96"	Varies by color	GREENGUARD Gold
SheerWeave 7000	Opaque	118"	100% polyester with acrylic foam backing	PVC Free/GREENGUARD Gold
SheerWeave 7100*	Opaque	72"/96"	PVC-coated fiberglass w/ laminated 2-ply 100% PVC blackout film	GREENGUARD Gold
SheerWeave Basic 3%	3%	98"	38% fiberglass / 62% vinyl on fiberglass	GREENGUARD Gold
SheerWeave Basic 5%	5%	98"	38% fiberglass / 62% vinyl on fiberglass	GREENGUARD Gold
<b>Mermet Fabric</b>				
Avila Twilight	Opaque	110"	37.5% polyester / 62.5% acrylic foam backing	PVC Free/GREENGUARD Gold
E Screen 7501*	1%	98"	36% fiberglass / 64% vinyl on fiberglass	GREENGUARD Gold
E Screen 7503*	3%	98"	36% fiberglass / 64% vinyl on fiberglass	GREENGUARD Gold
E Screen 7505	5%	98"	36% fiberglass / 64% vinyl on fiberglass	GREENGUARD Gold
E Screen 7510	10%	98"	36% fiberglass / 64% vinyl on fiberglass	GREENGUARD Gold
Flocke 11201	Opaque	78"	48% fiberglass / 52% acrylic flocked backing	PVC Free
M Screen 8503	3%	98"	36% fiberglass / 64% vinyl on fiberglass	GREENGUARD Gold
M Screen 8505	5%	98"	36% fiberglass / 64% vinyl on fiberglass	GREENGUARD Gold
S Screen*	4%	122"	33.6% fiberglass / 59.6% vinyl/ 6.8% polyester	GREENGUARD Gold
Satine	5%	98"	42% fiberglass / 58% vinyl on fiberglass	GREENGUARD Gold
T Screen	3%	98"	36% fiberglass / 64% vinyl	GREENGUARD Gold
Vela*	3%	118"	100% polyester	GREENGUARD Gold
<b>Other Available Fabrics</b>				
Balance*	7%	98"	100% polyester	PVC Free/GREENGUARD Gold
Hospitality: Sheer Lines*	30%	94.5"	100% polyester PVC-free	PVC Free
Hospitality: Texture	10%	98"	15% polyester / 85% vinyl on polyester	
Room Darkening	Opaque	72"	3-ply vinyl with 1-ply fiberglass	GREENGUARD Gold
Silverscreen	4%	94"	36% fiberglass / 64% vinyl w/ ultra-fine layer of aluminum	GREENGUARD Gold
Spectra*	10%	98"	100% polyester	PVC Free

\*Fabrics cannot be railroaded.

\*\* SheerWeave 5000 colors Tweed/Buckeye and Tweed/Oatmeal cannot be railroaded.